

Restroom Deadbolt Indicator (RDI)

For use with Schlage **B60N** Series Single Cylinder Deadbolt

These directions are supplemental to the deadbolt manufacturer's directions. Follow the manufacturer's directions for proper milling of the door for the deadbolt. Then return to these for assembling the deadbolt with the RDI. If you need the manufacturer's directions, visit our website.

Visit our website for additional assistance with your installation.



! FIRE RATED DOORS !

The RDI can not be used on fire rated openings.

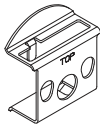

DO NOT INSTALL FIRE CUP

Standard Cylinder

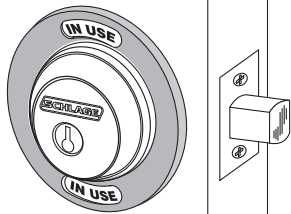

1

- Machine door per deadbolt Instructions.
- Install bolt in door. Follow manufacturer's directions.
- **Throw the bolt so it is extended in the locked position.**

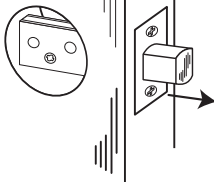

HANDING

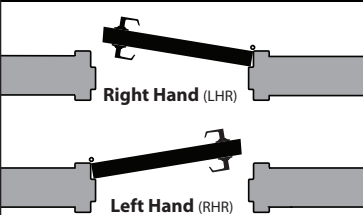

2

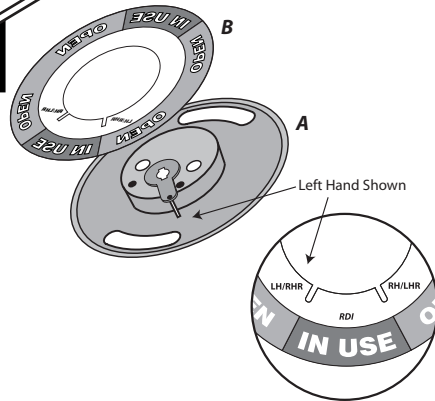

- See handing chart BELOW.

3

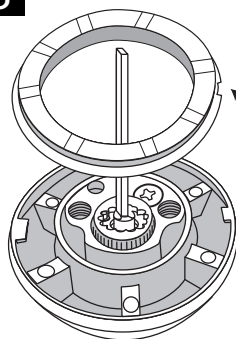

- On the back of the deadbolt, spin the back ring until the small notch and tab line up.
- Lift off the back ring and set aside. It is not needed for this installation.

4

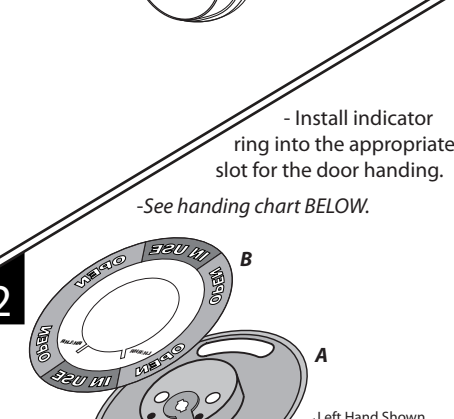

- Install indicator ring into the appropriate slot for the door handing.

5

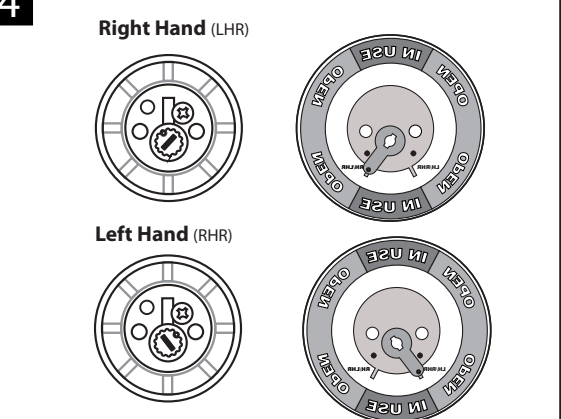

- Install deadbolt body and Indicator into door.
- Install thumbturn and deadbolt screws and **lightly** tighten.
- Slide indicator body up and down until key operates smoothly. Tighten screws.
- Finish installation per deadbolt manufacturer's directions.

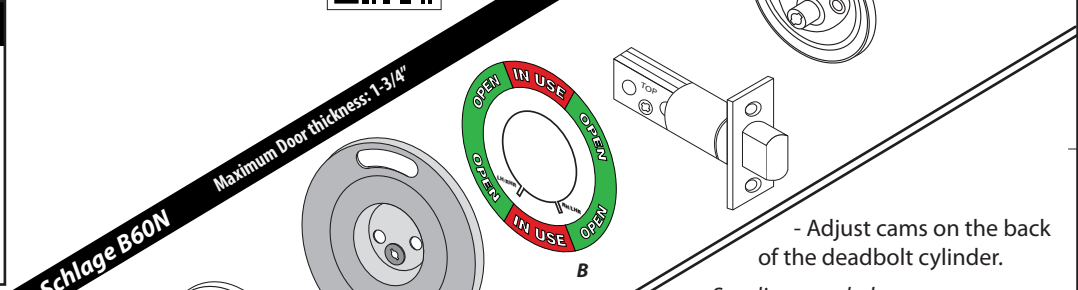
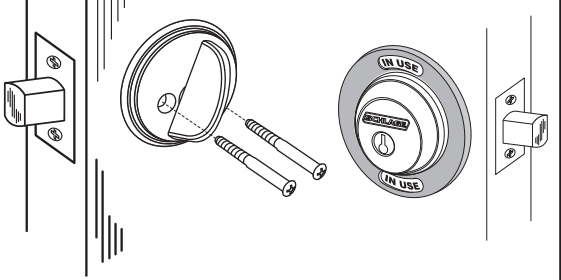

- Adjust cams on the back of the deadbolt cylinder.
- See diagrams below.

- Turn indicator disk so it reads **IN USE**.

- Install deadbolt body into indicator body.

Right Hand (LHR)

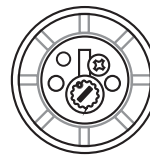

Left Hand (RHR)

