

Egress Deadbolt Indicator (EDI)

For use with Schlage B Series and Falcon D series Double Cylinder Deadbolt

These directions are supplemental to the deadbolt manufacturers directions. Follow the manufacturer's directions for proper milling of the door for the deadbolt. Then return to these for assembling the deadbolt with the EDI. If you need the manufacturer's directions, visit our website.

Visit our website for additional assistance with your installation.



! FIRE RATED DOORS !

The EDI can not be used on fire rated openings.

DO NOT INSTALL FIRE CUP

METAL SHIELD

*** DO NOT INSTALL ***

Schlage B662P *

Standard Cylinder

Schlage B562P & Falcon D131P & Falcon D231P

Door thickness: 1-3/4" (Up to 2-1/4" with additional parts)

Standard Cylinder

Schlage B662R (FSIC) & B662B (SFIC)

Door thickness: 1-3/4" - 2" (Up to 2-1/4" with additional parts)

Interchangeable Core

* Schlage B662 Series Recommended

Schlage B662R (FSIC) & B662B (SFIC)

Door thickness: 1-3/4" - 2" (Up to 2-1/4" with additional parts)

*All IC core deadbolts require the use of IC Collar D.

HANDING

Right Hand (LHR)

Left Hand (RHR)

The Egress Deadbolt Indicator is not manufactured or distributed by Schlage®, Falcon®, or Allegion.

1 Required on Schlage B562P & B662P and Falcon D131P & D231P

- Change tailpiece out on back of the **INSIDE** cylinder.
- The required tailpiece (**E**) measures 1 inch. Included with EDI.

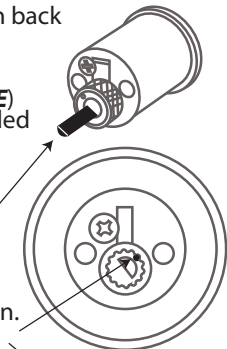
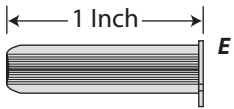

- Depress the shoulder pin. Unscrew retaining nut counter clockwise

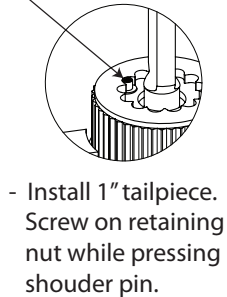
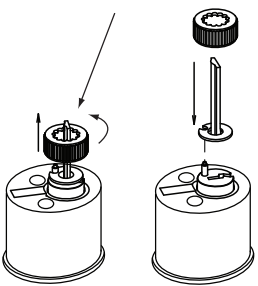

- Install 1" tailpiece. Screw on retaining nut while pressing shoulder pin.

- Insert key into the keyed cylinder & operate. Insure that the retaining nut is not too tight. If too tight, press shoulder pin and unscrew retaining nut by one or two notches.

- 2**
- Machine door per deadbolt instructions
 - Install bolt in door.

- **Throw the bolt so it is extended in the locked position.**

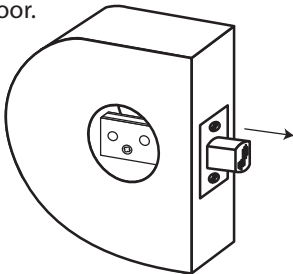

- 3**
- Install indicator ring into the appropriate slot for the door handing.
 - See handing chart on front page.

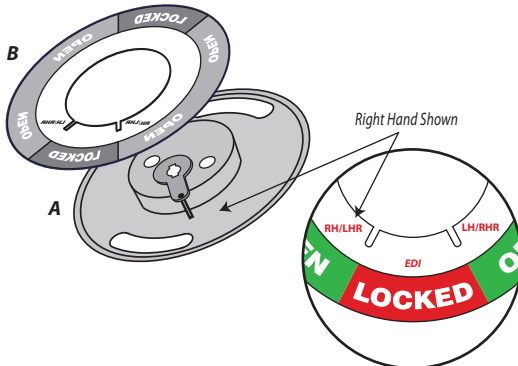

4 Interchangeable Cores (IC)

Schlage B662R (FSIC) & B662BD (SFIC)

Deadbolts with IC cores require the use of a spacing collar (Included in EDI). Install collar on the deadbolt cylinder housing before assembling deadbolt.

B662BD (SFIC)

Requires long tailpiece **G** (Included with EDI).

For doors thicker than 2" (2-1/4" thick MAX), two

G tailpieces are required, one for each cylinder housing. **Ordered separately.**

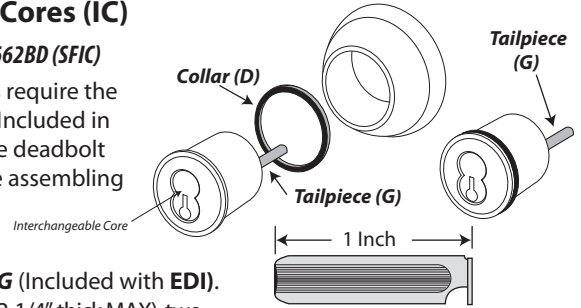

5

- Adjust tailpieces on the back of the **Inside Cylinder**.
- Turn indicator tailpiece so it reads **LOCKED**.
- Install inside deadbolt body into indicator body.

Right Hand (LHR)

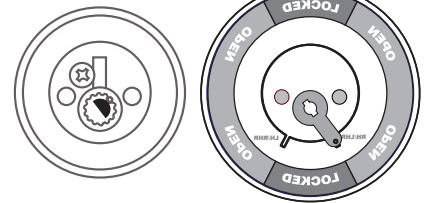

Left Hand (RHR)

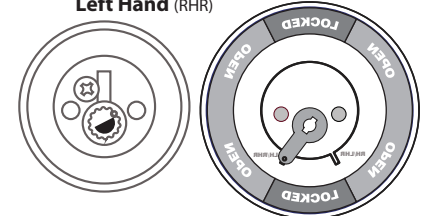

6

- Install red spacer disk **C** over cam with tab facing down.

- Press down and seat flat on indicator cam.

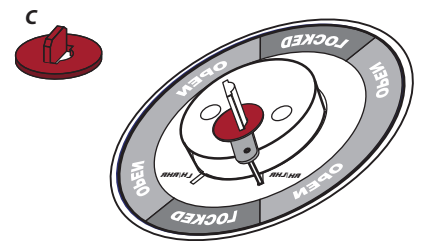
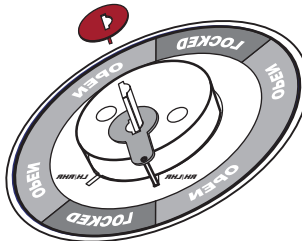

7

- Install outside deadbolt body into door. Install inside deadbolt body and indicator into door.
- Install long screws and tighten lightly.

- **Schlage B562P, Falcon D131P & D231P** (and doors thicker than 1-3/4"): Use the extra long screws included with the EDI.

- Adjust deadbolt body and indicator until key operates smoothly. Tighten screws.

⚠ DO NOT OVER TIGHTEN SCREWS ⚠

- Finish installation per deadbolt manufacturer's directions.

Use extra long screws for: Schlage B562P, Falcon D131P & D231P (and doors thicker than 1-3/4")



8

- Mount sign above door.

IBC 2015 **THIS DOOR TO REMAIN UNLOCKED WHEN THIS SPACE IS OCCUPIED**